



# Landslide

*UM Series Full Extension Undermount Slides for  
Frame and Frameless Cabinets (with locking device)*

## Features

- ♦ Load capacity: 75 lb.
- ♦ Material: Galvanized Steel
- ♦ Length: 305-533mm
- ♦ Full extension
- ♦ Tool free assembly and removal of drawer
- ♦ Soft Closing system guarantees smooth and quiet operation
- ♦ Drawer height adjustment 0~+3mm



Versions available for use with both  
16mm (5/8") and 19mm (3/4") drawer sides

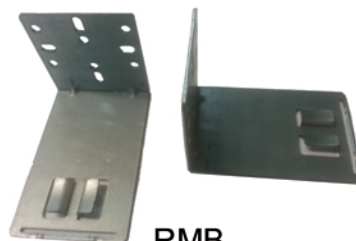

RMB  
(steel mounting bracket)

## Accessories



BS5  
(steel locking mechanism w/plastic handles)



BS1  
(plastic locking mechanism)



H-1041/1042  
(10mm dowels, offset w/32mm spacing)



H-1047/1048  
(10mm dowels, centered w/32mm spacing)

American Manufacturer's Supply 800-346-4042, fax 205-486-7585, [www.amscoinc.com](http://www.amscoinc.com)

## Drawer configurations for 16mm (5/8") drawer sides

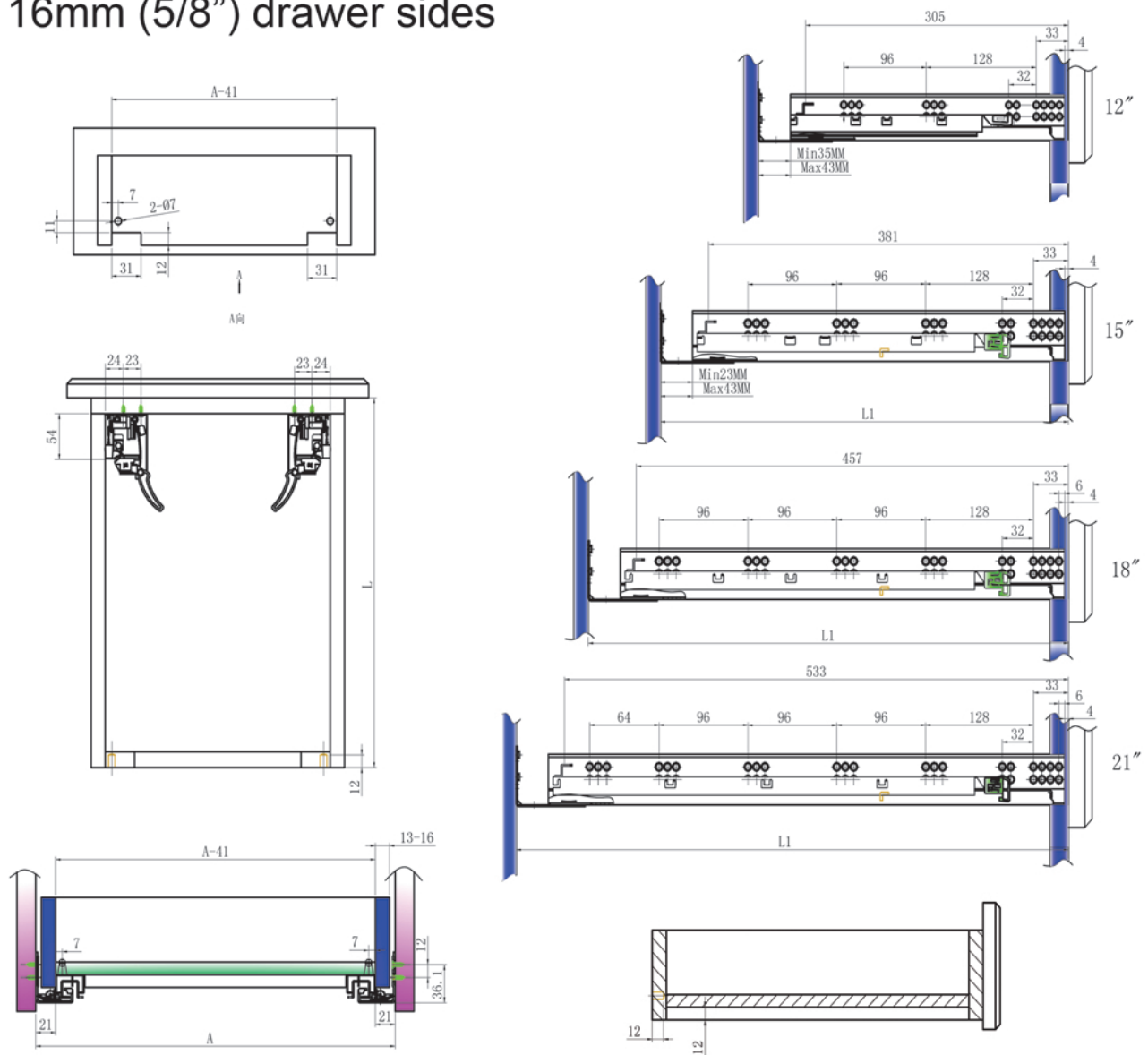

Nominal Length	12"	15"	18"	21"
Drawer Length L	305mm	381mm	457mm	533mm
Inside Cabinet Depth (min) L1	358mm	416mm	494mm	568mm
Inside Cabinet Depth (max) L1	366mm	436mm	514mm	588mm



**Landslide™**

800-346-4042 Fax 205-486-7585  
www.amscoinc.com

## Drawer configurations for 19mm (3/4") drawer sides

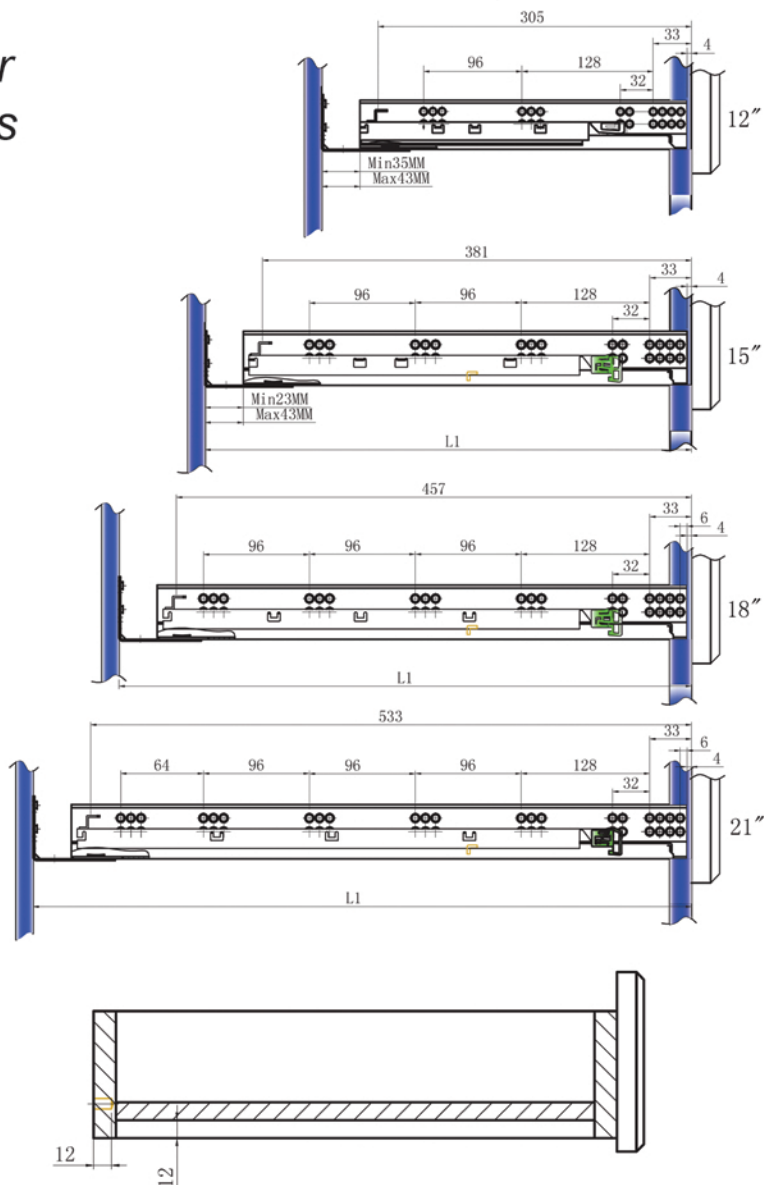
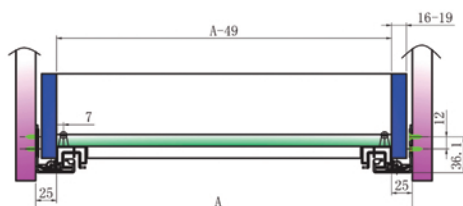
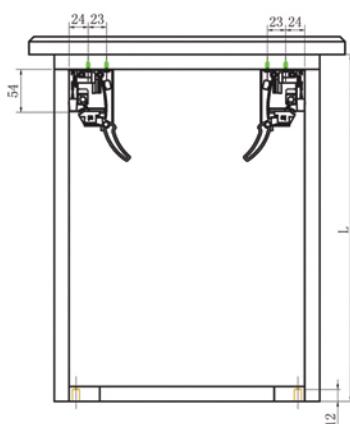
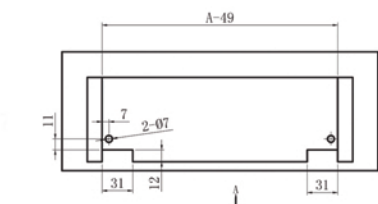

Nominal Length	12"	15"	18"	21"
Drawer Length L	305mm	381mm	457mm	533mm
Inside Cabinet Depth (min) L1	358mm	416mm	494mm	568mm
Inside Cabinet Depth (max) L1	366mm	436mm	514mm	588mm



**Landslide™**

800-346-4042 Fax 205-486-7585  
www.amscoinc.com