

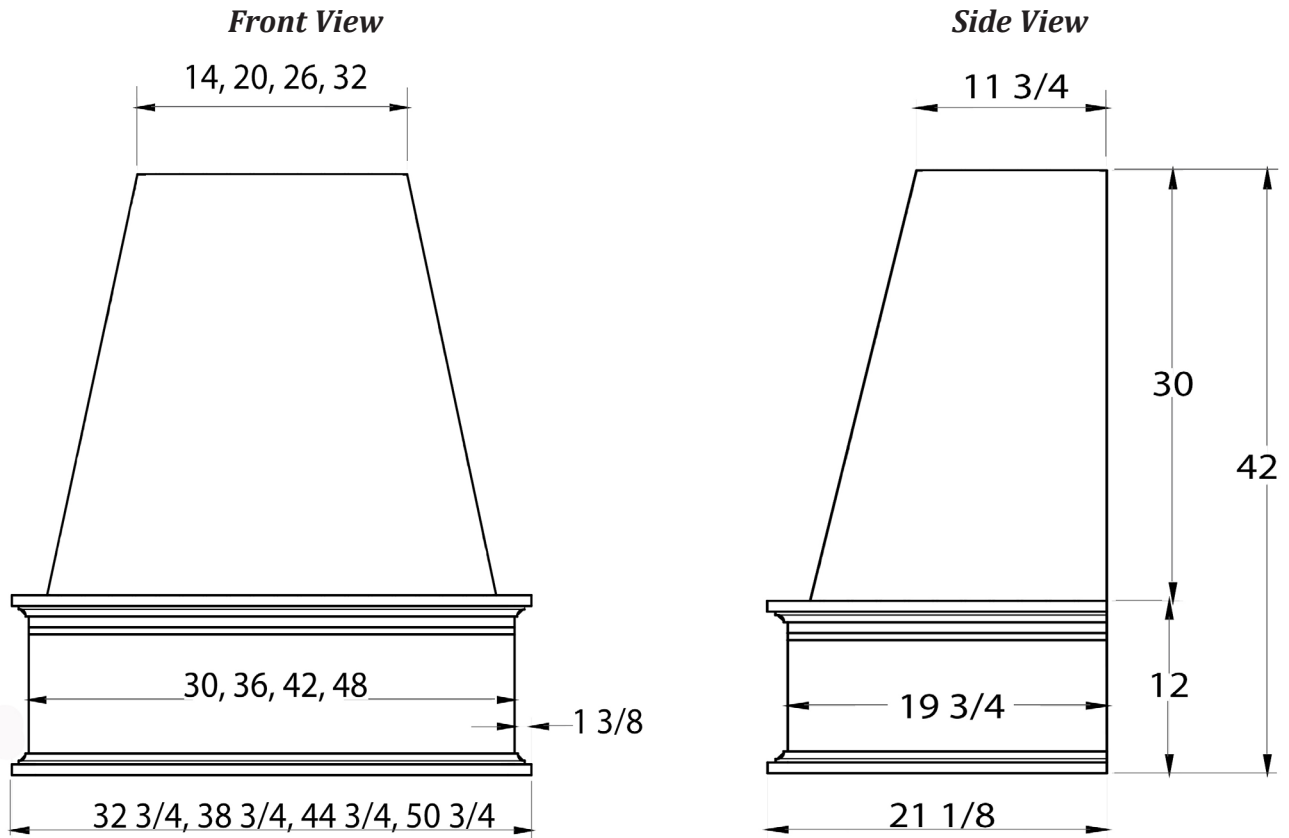

Tall Traditional Chimney Hood

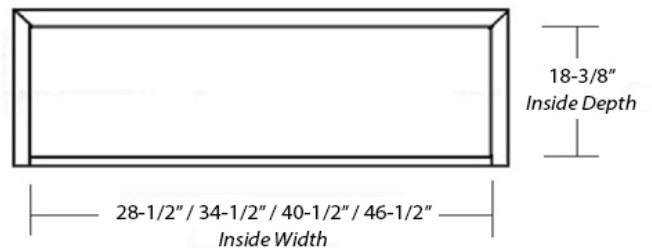

Item #	Dimensions (h) x (w) x (d)	Liner
SY-WCHH-30	42" X 32-3/4" X 21-1/8"	SY-HLB-30
SY-WCHH-36	42" X 38-3/4" X 21-1/8"	SY-HLB-36
SY-WCHH-42	42" X 44-3/4" X 21-1/8"	SY-HLB-42
SY-WCHH-48	42" X 50-3/4" X 21-1/8"	SY-HLB-48



- Hardwood Plywood and Solid Lumber Construction
- 1/2" Rear Plywood Stretchers for wall mounting
- Accepts SY-HLB series Powder Coated or Stainless Steel Liners *(sold separately)*
- Select from 300, 400, and 600 CFM Broan Ventilation power packs *(sold separately)* or
- Ascension 350SL, 350SS, 500SS and 620SS CFM Ventilation power packs *(sold separately)* or
- 30" and 36" models accept Ascension 900 CFM Professional Ventilators *(requires HLZ series Liners)*
- 42" and 48" models accept Ascension 1200 CFM Professional Ventilators *(requires HLZ series Liners)*
- Available in Alder, Cherry, Hickory, Maple and Red Oak
- Optional Detachable Upper Access available
- Optional 15", 24", and 36" height Chimney Extensions available

Base section will accommodate Ornaments in sizes up to 6" x 24"
www.castlewood.com

